

**1 UPPER MEZZANINE**  
SCALE: 1/16" = 1'-0"

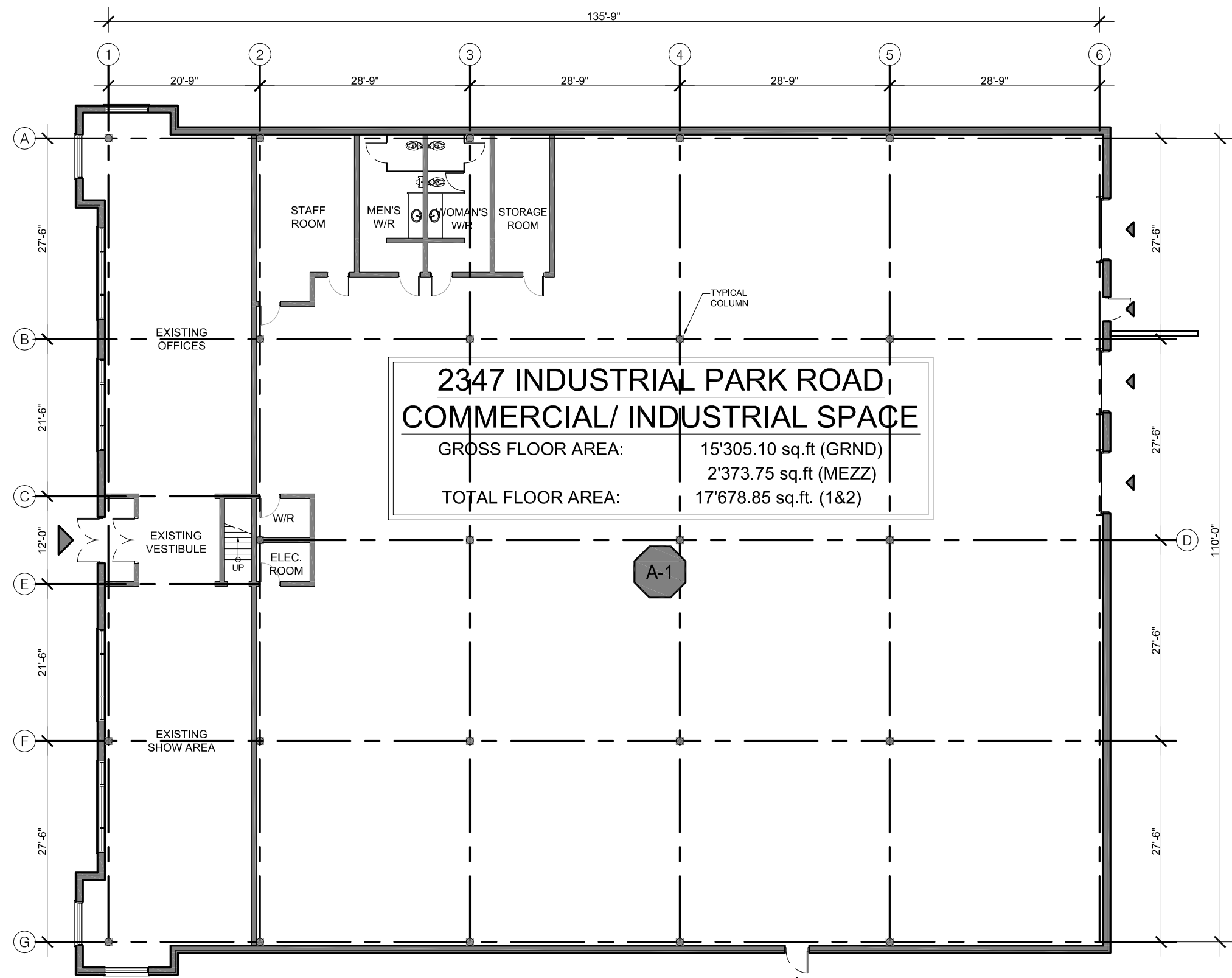

**2 LOWER LEVEL**  
SCALE: 1/16" = 1'-0"

**2347 INDUSTRIAL PARK ROAD  
COMMERCIAL/ INDUSTRIAL SPACE**  
GROSS FLOOR AREA: 15'305.10 sq.ft (GRND)  
2'373.75 sq.ft (MEZZ)  
TOTAL FLOOR AREA: 17'678.85 sq.ft. (1&2)

GROSS AREA SCHEDULE				
No.	SPACE AVAIL.	ZONING CLASSIFICATION	FIRE ACCESS	COMMENTS
A-1	WAREHOUSE	- COMMERCIAL - INDUSTRIAL	- ONE STREET	- 17'678 TOTAL FLOOR SPACE

1. DO NOT SCALE DRAWINGS.  
2. LANDLORD AND TENANT TO VERIFY TO USING CONTRACT REPORT ONLY AND ALL DISCREPANCIES TO THE DESIGNER PRIOR TO LEASE CONTRACT.  
3. THESE DRAWINGS ARE PROTECTED BY COPYRIGHT © BUILDING SERVICES LIMITED, 2008

SCALE:  
PROJECT NORTH

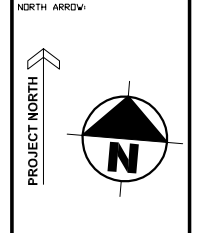

PROJECT:  
**2347 INDUSTRIAL PARK ROAD  
INNISFIL, ONTARIO**

DRAWN:  
DG

CHECKED BY:  
NN

SCALE:  
AS NOTED

DATE:  
FEB. 7/08

PROJECT NO:  
08101

SHEET TITLE:  
**PROPOSED LEASABLE SPACE**

REVISION NO:  
-

SHEET NO:  
**A1**